

WOODEN LEGS STAND

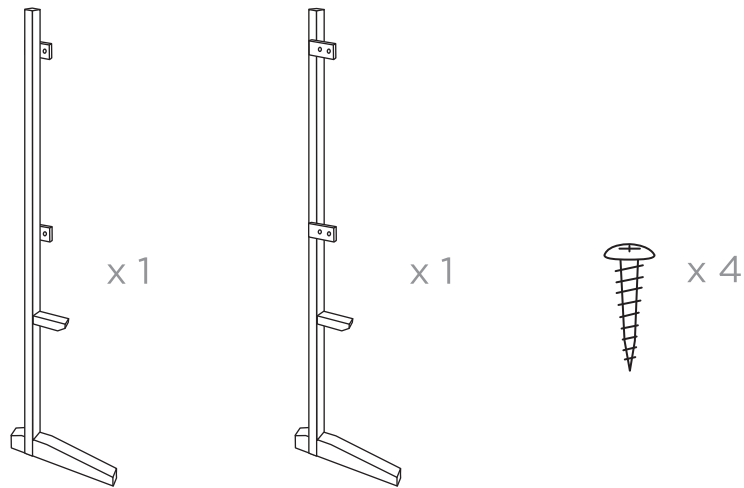

- 1** Place panel on its side. Position leg next to panel with foot facing towards front and support strut flush against bottom of panel. Screw in place using screws provided. (Ensure you use the correct leg on the correct side).

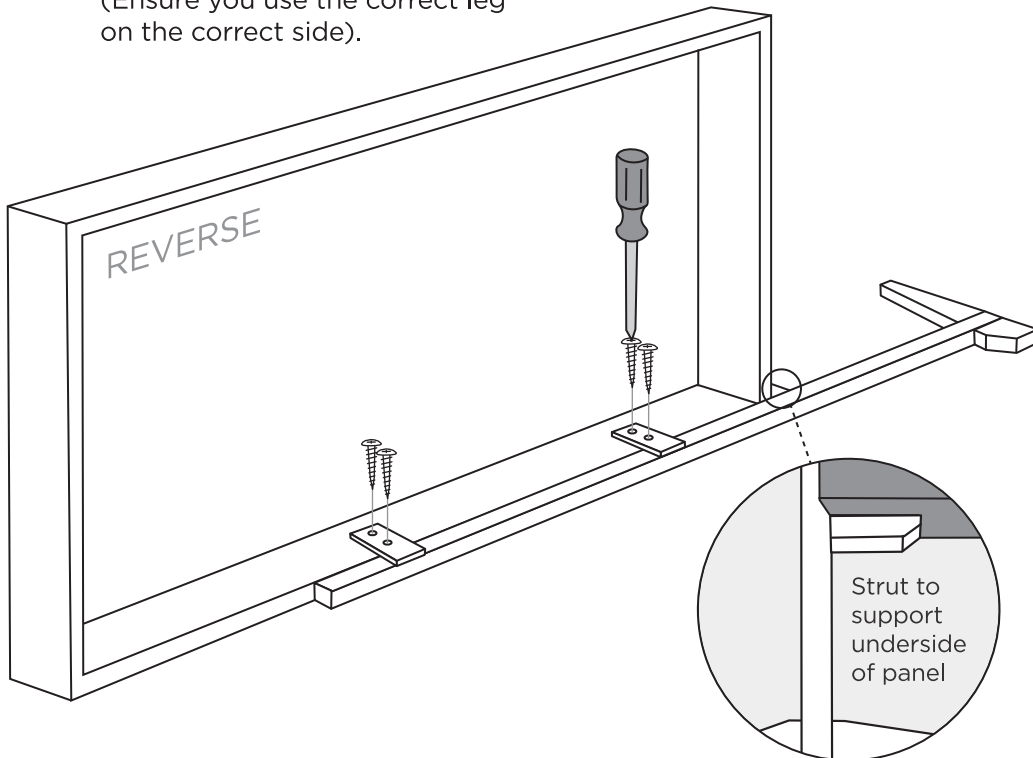

- 2** Flip the panel over and repeat the steps on the other side.
- 3** Stand the panel up on its legs and place against a wall for extra support.

