

FRENCH CLEATS

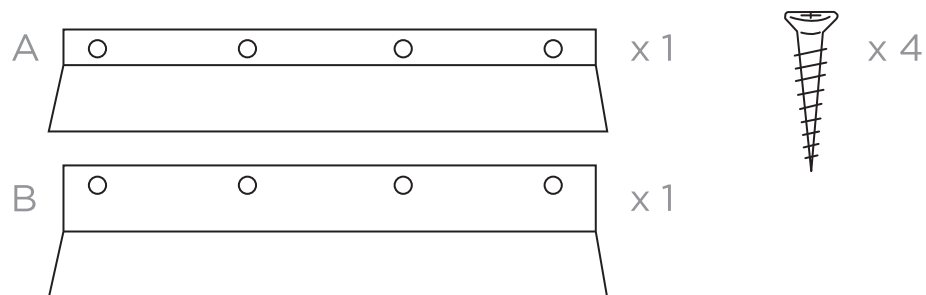

- 1 Screw smaller cleat (A) onto centre back of panel using screws provided.

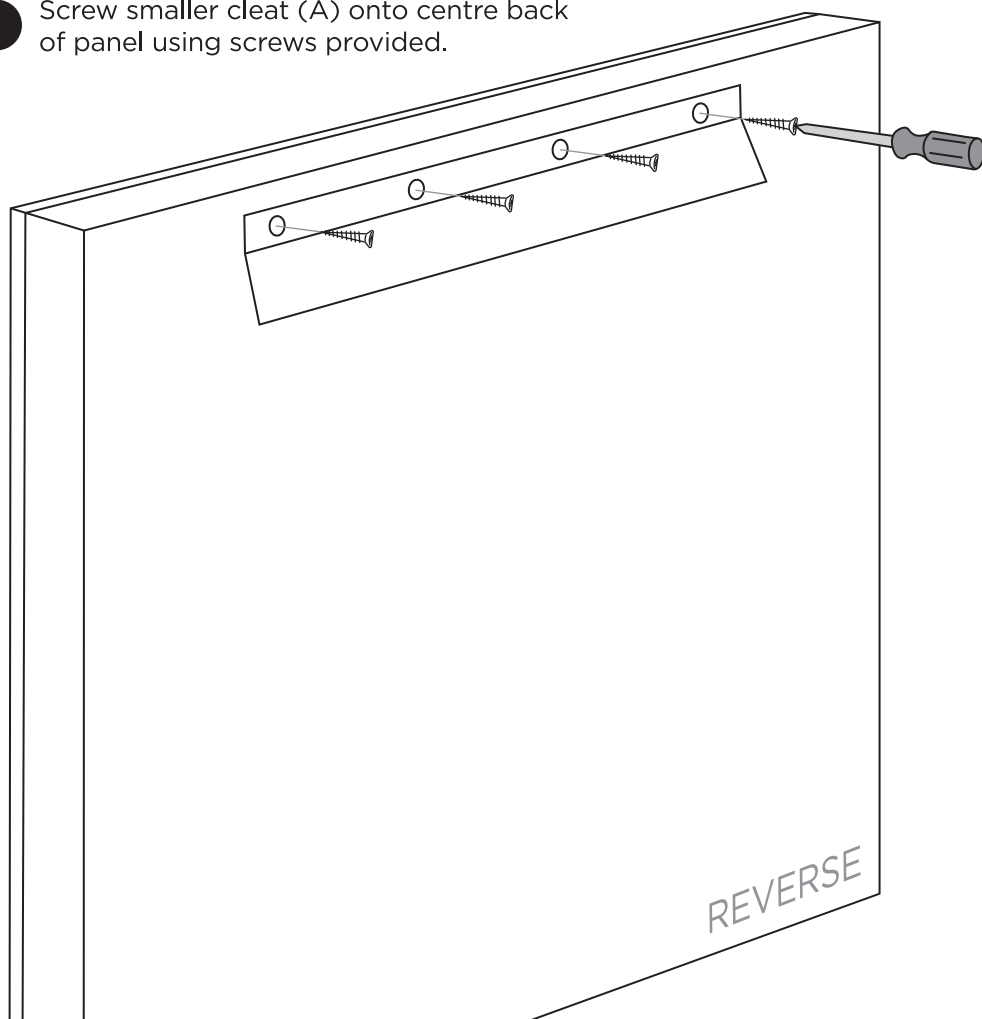

- 2 Attach larger cleat (B) to wall using correct plugs and screws for wall type.

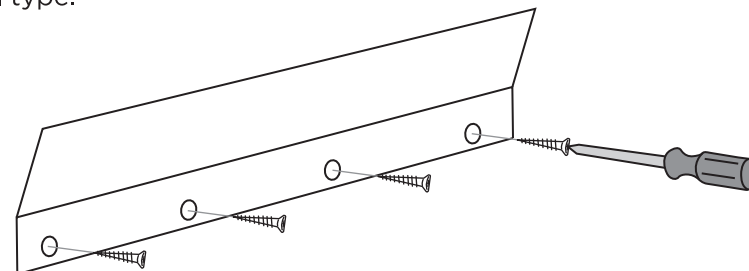

- 3 Slide panel down onto wall cleat so cleats interlock. Panel can be adjusted left or right without tipping.

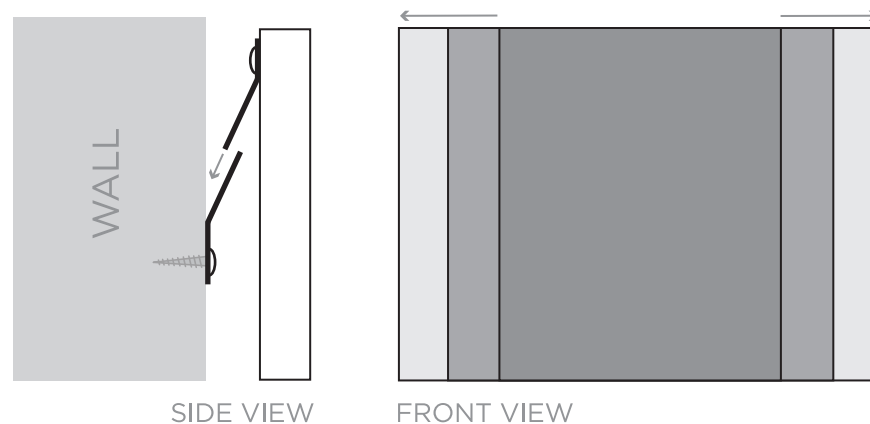

- 4 French cleats can also be used to fit corner Tri Trap panels. Remove plastic protective sheet from top and bottom of panel. Fix cleats as per previous instructions (1-3) on 2 sides.

